



# CANTERBURY HORTICULTURAL CENTRE

The Canterbury Horticultural Centre venue in Christchurch is located in Hagley Park South, positioned adjacent to the world renowned Botanic Gardens. It is the premises of the Canterbury Horticultural Society.

There are four dedicated event spaces in a range of sizes, giving a versatile venue to host your next event.

Event spaces are:

The **Templin Hall** provides a blank canvas for your event. Access doors from the foyer, the main carpark and through the loading dock allow for ease of set up and entry for your participants at this downstairs venue.

The **Templin Hall** maximum capacity

- Theatre style seating for 300
- Classroom seating - 100
- Standing cocktail party - 400
- Banquet seating -200

The Templin Hall dimensions

- 24 m (long) x 19 m (wide)
- 456 sq metres floor space
- has upper mezzanine 24m (long) x 3.6m (wide)
- further 86 sq metres floor space
- floor is half carpet, half wooden

On site equipment

- chairs 250
- tables - trestles
- screen - on wall for visual presentations
- preparation room
- pa system
- kitchen and servery
- additional equipment is available through suppliers

TEMPLIN HALL

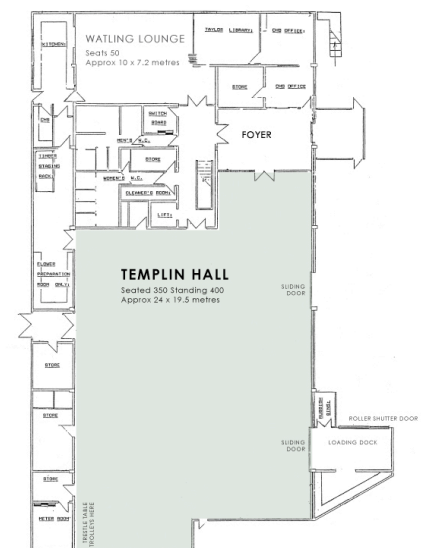

The **Watling** is a welcoming lounge space suitable for smaller groups and presentations on the ground floor of the Horticultural Centre.

The **Watling Lounge** maximum capacity

- Theatre style seating for 50
- Classroom seating - 20
- Standing cocktail party - 60

The Watling Lounge dimensions

- 10 m (long) x 7.2 m (wide)
- 72 sq metres floor space
- floor is fully carpeted

On site equipment

- chairs - 50
- tables - squares
- portable whiteboard
- kitchen and servery
- additional equipment is available through suppliers

#### WATLING LOUNGE

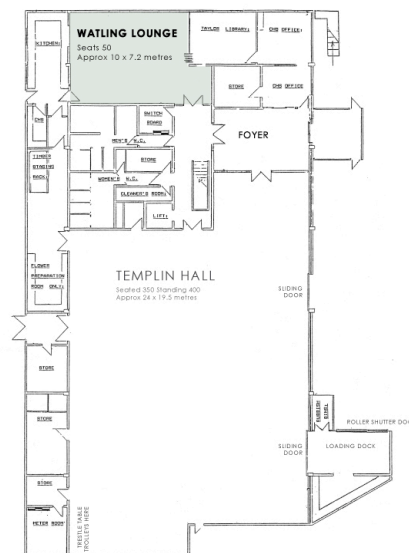

The upstairs **Board Room** is ideal for a formal meeting with its Board Table and heritage chairs.

The **Board Room** maximum capacity

- board room seating - 20

The Board room dimensions

- 7 m (long) x 7 (wide)
- 49 sq metres floor space

#### BOARD ROOM

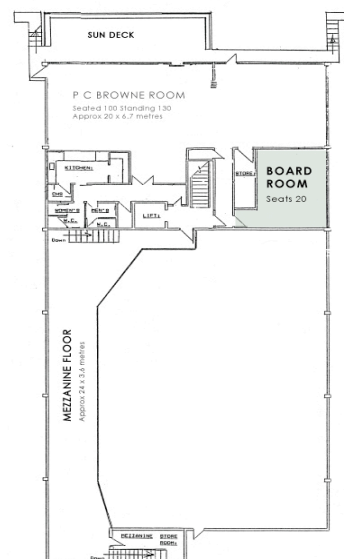

The **P C Browne Room** is a bright open upstairs space. At mid room there is a split level with a room divider.

The **P C Browne Room** maximum capacity

- Theatre style seating - 100
- Classroom seating - 50
- Standing cocktail party - 130
- Banquet seating - 40

The P C Browne Hall dimensions

- 20 m (long) x 6.7 m (wide)
- 134 sq metres floor space
- floor is fully carpeted

On site equipment

- chairs - 60
- tables - trestle and squares
- screen - on wall for visual presentations
- kitchen and servery
- additional equipment is available through suppliers

#### P C BROWNE ROOM

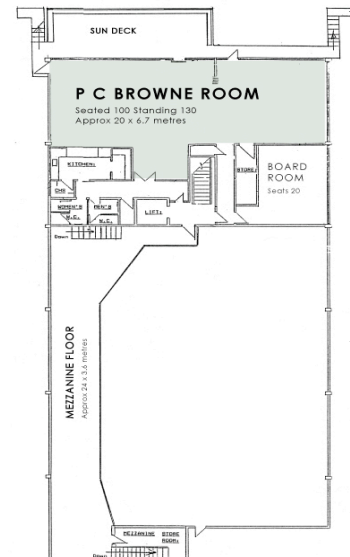

The Horticultural Centre has Canterbury Horticultural Society staff on site Monday to Friday from 8.30a.m. to 5.00p.m. providing a reservation and support service for your event.

Cleaning of the venue after your use is available through our own cleaner.

# HIRE RATES

Horticultural Centre Charges - effective 1 October 2011

## Notes

All charges are inclusive of GST at 15%

Use of furniture (chairs and tables) as supplied in each room are included

To set out and restack chairs and tables \$40.00 per hour

To clean after a function \$40.00 per hour with a minimum of \$250.00

Bond for use of venue \$350.00

## Templin Hall (downstairs main hall)

Session rate - 1/2 day	\$225.00
Two sessions	\$450.00
Three sessions	\$675.00
Weddings/ Social Functions	\$850.00

## Watling Lounge (downstairs lounge)

Session rate - 1/2 day	\$60.00
Two sessions	\$120.00
Three sessions	\$180.00
Weddings/ Social Functions	\$250.00

## P C Browne (upstairs lounge)

Session rate - 1/2 day	\$85.00
Two sessions	\$170.00
Three sessions	\$255.00
Weddings/ Social Functions	\$400.00

## Boardroom (upstairs) for committee meeting or similar

Session rate - 1/2 day	\$50.00
Two sessions	\$80.00
Three sessions	\$120.00

PC Browne Room Bond	\$200.00
PC Browne Room Cleaning	\$100.00
Templin Hall Bond	\$350.00
Templin Hall Cleaning	\$250.00

## Complex ( 1 day)

includes Templin Hall, Watling Lounge, PC Browne

Deposit	\$150.00
Hire of complex	\$850.00

**Total for function \$1,100.00**

For inquiries please contact:

Canterbury Horticultural Society  
57 Riccarton Ave, P.O.Box 369  
Christchurch  
T: 03 366 6937 F: 03 365 2759  
E: office@chsgardens.co.nz  
www.chsgardens.co.nz



P.O.Box 369, 57 Riccarton Ave,  
Christchurch 8150  
T: 03 3666 937  
www.chsgardens.co.nz,  
E: office@chsgardens.co.nz